

RE-Under-Cover Doorframes

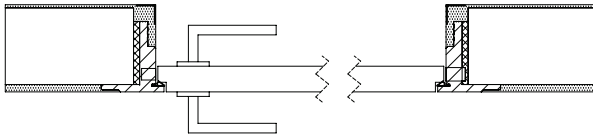

Single door

	A Structural wall opening			B Door dimension			H UC rebate size			F Frame outer dimension			I Frame outer edge dimension			C Clearance dimension		
Width	+ 90 mm			0			+ 7 mm			+ 176 mm			+ 56 mm			- 48 mm		
	Height	x	Width	Height	x	Width	Height	x	Width	Height	x	Width	Height	x	Width	Height	x	Width
			674			584			591			760			640			536
			799			709			716			885			765			661
			924			834			841			1010			890			786
			1049			959			966			1135			1015			911
Height			1174			1084			1091			1260			1140			1036
			1299			1209			1216			1385			1265			1161
	+ 48 mm			0			+ 8 mm			+ 93 mm			+ 33 mm			- 5 mm		
	2063		2015			2023			2108			2048			2010			
	2163		2115			2123			2208			2148			2110			
	2270		2222			2230			2315			2255			2217			
Height	2395		2347			2355			2440			2380			2342			
	2520		2472			2480			2565			2505			2467			
	2645		2597			2605			2690			2630			2592			
	2770		2722			2730			2815			2755			2717			
	2895		2847			2855			2940			2880			2842			
	3020		2972			2980			3065			3005			2967			

Unfinished wall thickness minimum 100 mm
Dimensions without chiseling

For mounting with a metal stud wall / dry wall please use a reinforced U profile with wood.
The profile must be screwed at the bottom and at the ceiling.
The corner profile should be of non-magnetic material due to the magnetic lock.

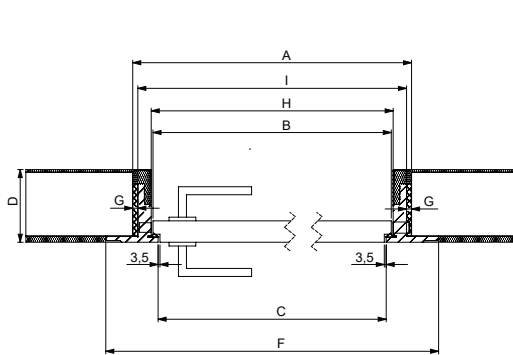

OKFF = Oberkante Fertig Fußboden
Top finished floor

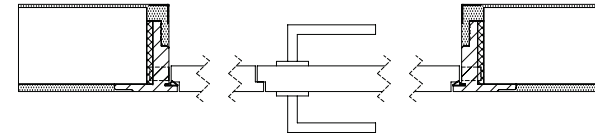
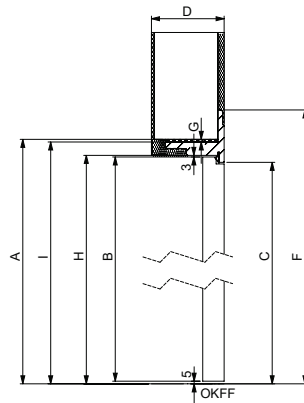

Double door

	A Structural wall opening			B Door dimension			H UC rebate size			F Frame outer dimension			I Frame outer edge dimension			C Clearance dimension		
Width	+ 90 mm			0			+ 7 mm			+ 176 mm			+ 56 mm			- 77 mm		
	Height	x	Width	Height	x	Width	Height	x	Width	Height	x	Width	Height	x	Width	Height	x	Width
			1524			1434			1441			1610			1490			1357
			1774			1684			1691			1860			1740			1607
			2024			1934			1941			2110			1990			1857
Height	+ 48 mm			0			+ 8 mm			+ 93 mm			+ 33 mm			- 5 mm		
	2063		2015			2023			2108			2048			2010			
	2163		2115			2123			2208			2148			2110			
	2270		2222			2230			2315			2255			2217			
	2395		2347			2355			2440			2380			2342			
	2520		2472			2480			2565			2505			2467			
Height	2645		2597			2605			2690			2630			2592			
	2770		2722			2730			2815			2755			2717			
	2895		2847			2855			2940			2880			2842			
	3020		2972			2980			3065			3005			2967			

* 2 x 722 mm
* 2 x 847 mm
* 2 x 972 mm

Unfinished wall thickness minimum 100 mm
Dimensions without chiseling

For mounting with a metal stud wall / dry wall please use a reinforced U profile with wood.
The profile must be screwed at the bottom and at the ceiling.
The corner profile should be of non-magnetic material due to the magnetic lock.

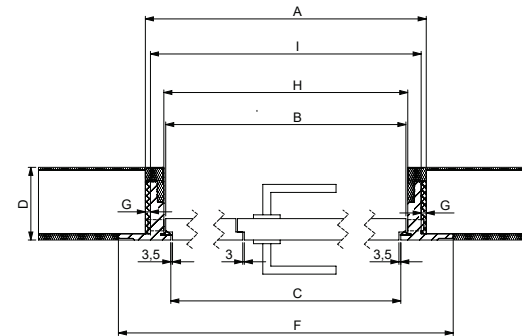

OKFF = Oberkante Fertig Fußboden
Top finished floor

